



METHODOLOGY FOR EXTERIAR WALL COATING

1. SURFACE PREPARATION

The surface to be coated must be sound and clean, free of all traces of paints, coatings, efflorescence, loose particles, grease, oil, de-molding agents, dust, gypsum plaster, etc. Chisel all the unwanted / dead concrete and clean the entire surface by using wire brush.

2. CRACK FILLING

Open all the cracks and fill-up with our Acrylic filling paste **STARFIX ACF 609**.

3. PRIME COAT

Applying one coat of **STARPROOF SUPER PRIME** (Acrylic Based Deep impregnating primer) on the entire surface of the external walls. Curing would be made by drying until 4 hrs. is attained prior to the succeeding coat to be applied.

4. COATING

After complete drying of the primer and bonded areas, Apply 2 coats of **STARPROOF WF WALLCOAT** with brush, roller or spray gun. A brush with horse hair bristles will provide almost texture-free, smooth surfaces. Dilution up to 10% for 1st coat and 5% for 2nd coat is allowable.

Note: Each coat shall have an interval time of 6-8 hrs for curing.

5. COVERAGE

Coverage depend upon the nature of the surface to be applied.

But on average, smooth surface will give 30 ± 3 sq ft per kg for a 2 coat application. Two coats will give approximately 200 to 250 microns dry film thickness.

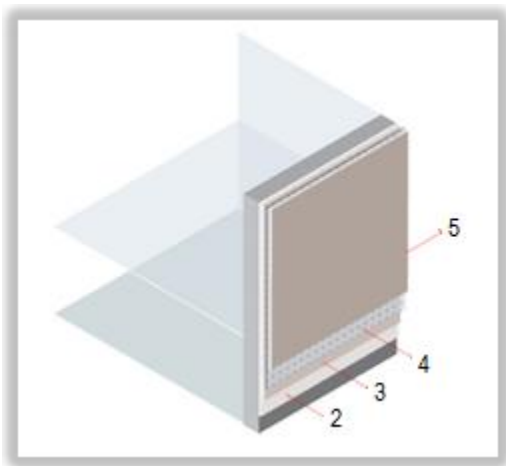

INDIA

Tel. +91 9712925770
Email: - info@ssplchem.com
www.star-uae.com

KSA

Tel. +996 12 677 7073
Email: - ksa@star-uae.com
www.star-uae.com

UAE

Tel. +971 6 5611411
Email: - uae@star-uae.com
www.star-uae.com